

file name: C:\drawings\BENAS\BA-12-1046.dwg

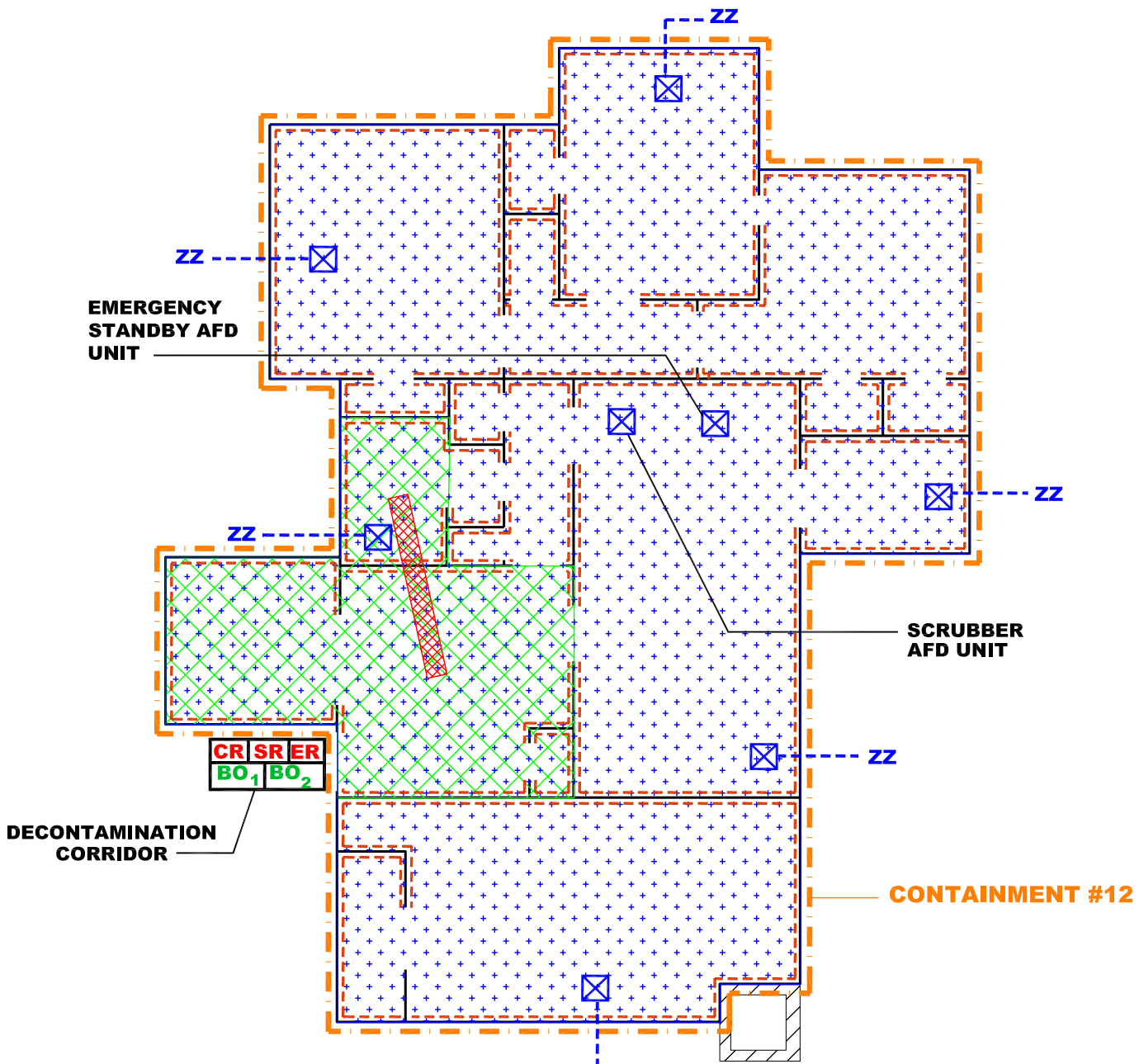

LEGEND 1:

- ACM Wall Texture & Joint Compound to be removed (approx. 3,176 SF)
- ACM Ceiling Texture & Joint Compound to be removed (approx. 936 SF)
- ACM Flooring Materials to be removed (approx. 236 SF)
- ACM TSI in crawlspace to be removed (approx. 85 LF)

LEGEND 2:

- Containment Barrier #9
- Air Filter Device (AFD)
- AFD Exhaust Route
- ER** Equipment (dirty) Room
- SR** Shower Room
- CR** Clean Room
- BO<sub>1</sub>** Waste Bags Wash Down Room
- BO<sub>2</sub>** Double Bagging of Waste Room

FIGURE 12

**Asbestos-Containing-Materials Abatement**  
 Single Family Residence  
 23 Carswell Street (TSTC Campus)  
 3801 Campus Drive  
 Waco, Texas 76705  
**BENAS Project No.: BA-12-1046**



**BENAS**  
 Environmental Services, Inc.  
 ENVIRONMENTAL CONSULTANTS  
 324 CROOKED TREE COURT  
 COPPELL, TEXAS 75019  
 PHONE: (972) 393-0128 FAX: (972) 393-0793

**HATCHING & LOCATIONS FOR ASBESTOS-CONTAINING MATERIALS TO BE REMOVED**  
 Prepared for: Texas State Technical College (TSTC)  
 Attention: Mr. Mike Ratcliff, Project Manager  
 Prepared by: Ephraim Okotcha "EO"  
 TDSHS Licensed Asbestos Consultant No.: 10-5399